

Driver: Zac Ryan

 Track: FEMCA Sydney

Air Temp: \_\_\_\_\_

 Surface Description: Very Grippy and rough

Lap Time: \_\_\_\_\_

## Front Suspension

Shock Spring: Silver  
 Shock Piston: 1.4mm x 6 holes  
 Shock Oil wt: 40wt Losi  
 Shock Length (Center to Center): Short shock ends  
 Toe-In: \_\_\_\_\_  
 Toe-Out: 2 degrees  
 Front Ride Height: Arms slightly above level  
 Sway Bar: 2.6mm  
 Camber: Neg: 4.5 neg  
 Pos: \_\_\_\_\_  
 Camber Block:  A/A  B- Blocks

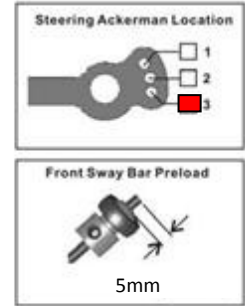
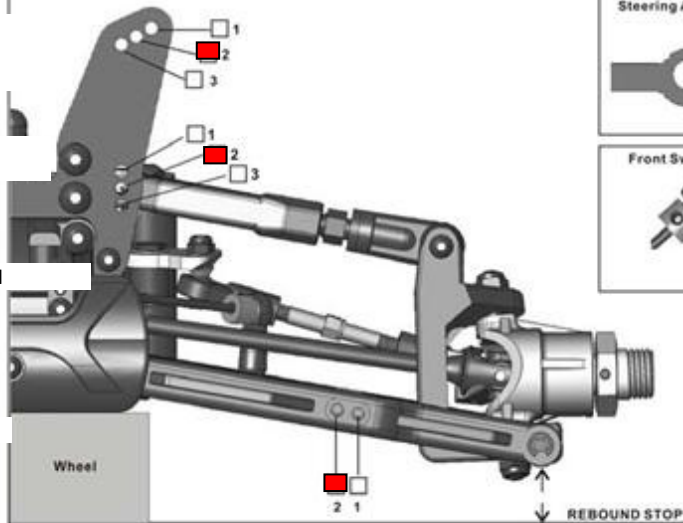
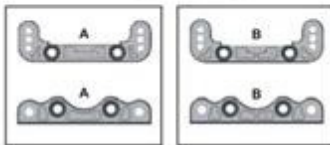
 Notes: Full Droop

## Rear Suspension

Shock Spring: White  
 Shock Piston: 1.4mm x 6  
 Shock Oil wt: 32.5 wt losi  
 Shock Length (Center to Center): Long shock ends  
 Rear Ride Height: Arms slightly above level  
 Sway Bar: 2.8mm  
 Camber: Neg: 5 Degrees  
 Pos: \_\_\_\_\_  
 Rear Hub/Wheelbase: Forward (2 mm taken off front of hub and moved further forward)

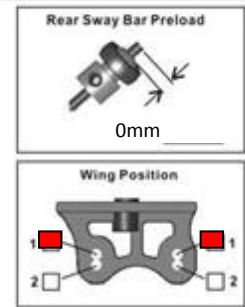
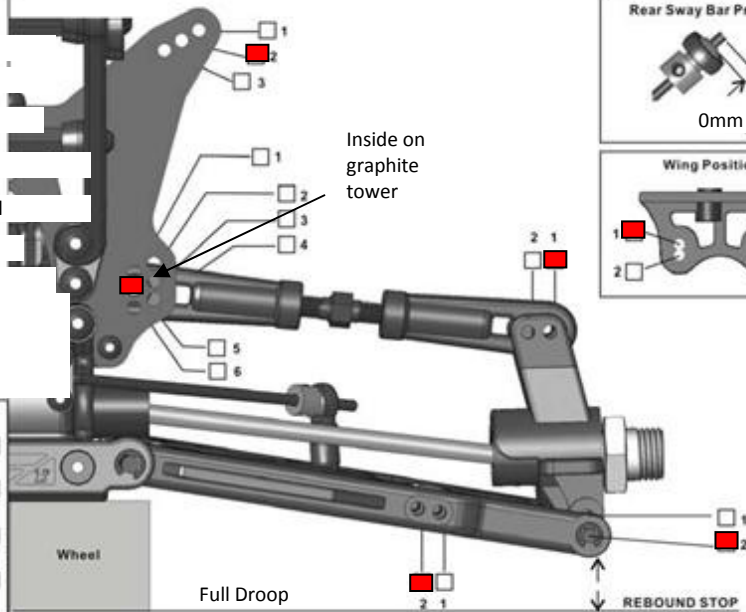
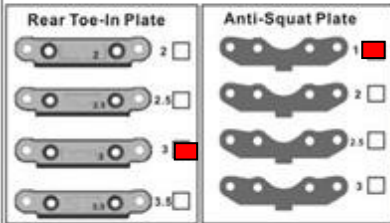

## Differentials

Front Type: \_\_\_\_\_ Oil: 7  
 Center Type: \_\_\_\_\_ Oil: 5  
 Rear Type: \_\_\_\_\_ Oil: 3

## Tires

Front Type: \_\_\_\_\_ Compound: \_\_\_\_\_ Foam: VP Molded  
 Rear Type: \_\_\_\_\_ Compound: \_\_\_\_\_ Foam: VP Molded  
 Note: VP Pro 802 standard medium

## Engine

Type: Axe Rossi Evo  
 Head Clearance: Pip2050  
 Fuel: AT Racing Plug: RT5  
 Needle (Top): \_\_\_\_\_ (Bottom): \_\_\_\_\_  
 Note: \_\_\_\_\_

## Clutch

Shoe Brand: HN Compound: RED  
 Spring Brand: \_\_\_\_\_ Tension: GOLD  
 Gearing:  13T  14T To  46T  48T  
 Note: 17 clutch bell 55 spur gear